

Douglas A. Ducey
Governor



Lisa A. Atkins
Commissioner

Arizona State Land Department

1616 West Adams, Phoenix, Arizona 85007

NOTIFICATION OF PENDING APPLICATION

University of Arizona
Board of Regents
Attn: Bruce Vaughan
P.O. Box 210300, 220 W. 6th St.
Tucson, AZ 85721

Date: July 11, 2022

Applicant Name: Rosemont Copper Company

Application No.: 14-123251-00-100

Purpose: Access road, 3 pipelines, electrical and telecommunication lines

Your Lease No.: 03-99671-00

You are being notified that the Arizona State Land Department ("Department") has received an application for a right of way across State Trust land which may affect your Lease.

Above is information submitted to the Department which identifies the applicant name and purpose of the application. If provided by the applicant, a legal description, map, or plat is enclosed.

Please note this application is in the preliminary stages, and no decision has been made by the Department. All pending applications to lease, purchase, or use State Trust land confers no rights to the applicant.

If you would like to provide comments relative to this application, please submit them through the Department's website at <https://land.az.gov/contact>, or if you do not have access to a computer, send your comments to:

Arizona State Land Department
Attn: Right of Way Section
1616 W. Adams St.
Phoenix, AZ 85007

When submitting your comments, please include the Application No. listed above.

Thank you.

Enc.

AN EASEMENT SITUATED IN THE SOUTHEAST QUARTER OF SECTION 16, AND THE NORTHEAST QUARTER OF SECTION 21, BOTH OF TOWNSHIP 18 SOUTH, RANGE 15 EAST, WITHIN THE COUNTY OF PIMA, STATE OF ARIZONA, MORE PARTICULARLY DESCRIBED AS FOLLOWS:

BEGINNING AT A STONE FOUND AT THE SOUTHEAST CORNER OF SAID SECTION 16, FROM WHICH AN ALUMINUM CAPPED PIN STAMPED LS 13178 FOUND AT THE EAST QUARTER CORNER OF SAID SECTION 16 BEARS NORTH 00 DEGREES 10 MINUTES 18 SECONDS WEST, 2640.63 FEET DISTANT;

THENCE, ALONG THE EAST LINE OF SECTION 16, NORTH 00 DEGREES 10 MINUTES 18 SECONDS WEST, 1000.00 FEET;

THENCE, DEPARTING SAID EAST LINE OF SECTION 16, SOUTH 89 DEGREES 49 MINUTES 42 SECONDS WEST, 150.00 FEET;

THENCE, PARALLEL WITH THE EAST LINE OF SAID SECTION 16, SOUTH 00 DEGREES 10 MINUTES 18 SECONDS EAST, 1000.05 FEET, TO THE SOUTH LINE OF SAID SECTION 16;

THENCE, PARALLEL TO THE EAST LINE OF SAID SECTION 21, SOUTH 00 DEGREES 12 MINUTES 33 SECONDS EAST, 2320.05 FEET;

THENCE, NORTH 89 DEGREES 47 MINUTES 27 SECONDS EAST, 150.00 FEET, TO A POINT ON THE EAST LINE OF SAID SECTION 21;

THENCE, ALONG THE EAST LINE OF SAID SECTION 21, NORTH 00 DEGREES 12 MINUTES 33 SECONDS WEST, 2320.00 FEET, TO THE **POINT OF BEGINNING**.

CONTAINING 498,007 SQUARE FEET, OR 11.433 ACRES, MORE OR LESS.

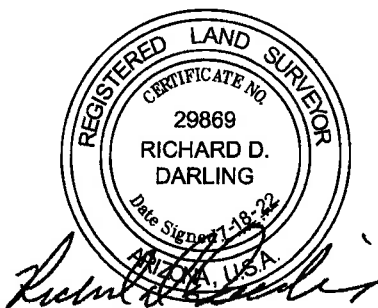

EXHIBIT "A"

FND ALUM CAPPED
IRON ROD LS 13178



2640.63
N0° 10' 18"W
BASIS OF
BEARINGS

S89° 49' 42"W
150.00'

S0° 10' 18"E
1000.05'
1000.00'
N0° 10' 18"W

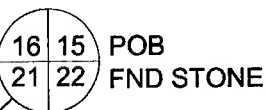

POB
FND STONE



(IN FEET)
1 inch = 500 ft.

SUBJECT PARCEL

S0° 12' 33"E
2320.05'
2320.00'
N0° 12' 33"W

N89° 47' 27"E
150.00'

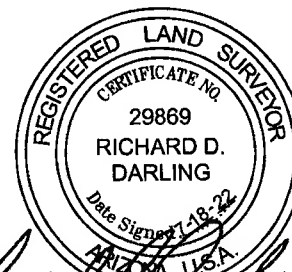

Richard D. Darling
ARIZONA, U.S.A.

PREPARED FOR:

ROSEMONT COPPER



9040 S. RITA ROAD
SUITE 2350
TUCSON, AZ 85747
(520)-298-2725 (O)
(520)-298-2767 (F)
www.darlingtd.com

TITLE

EXHIBIT TO ACCOMPANY LEGAL
DESCRIPTION

DRAWING No.

JOB# RCC-SU21-044
DATE: JULY 2022

REVISION

